

# LOCATION PLAN

Scale 1/2500 based on O.S. sheet.

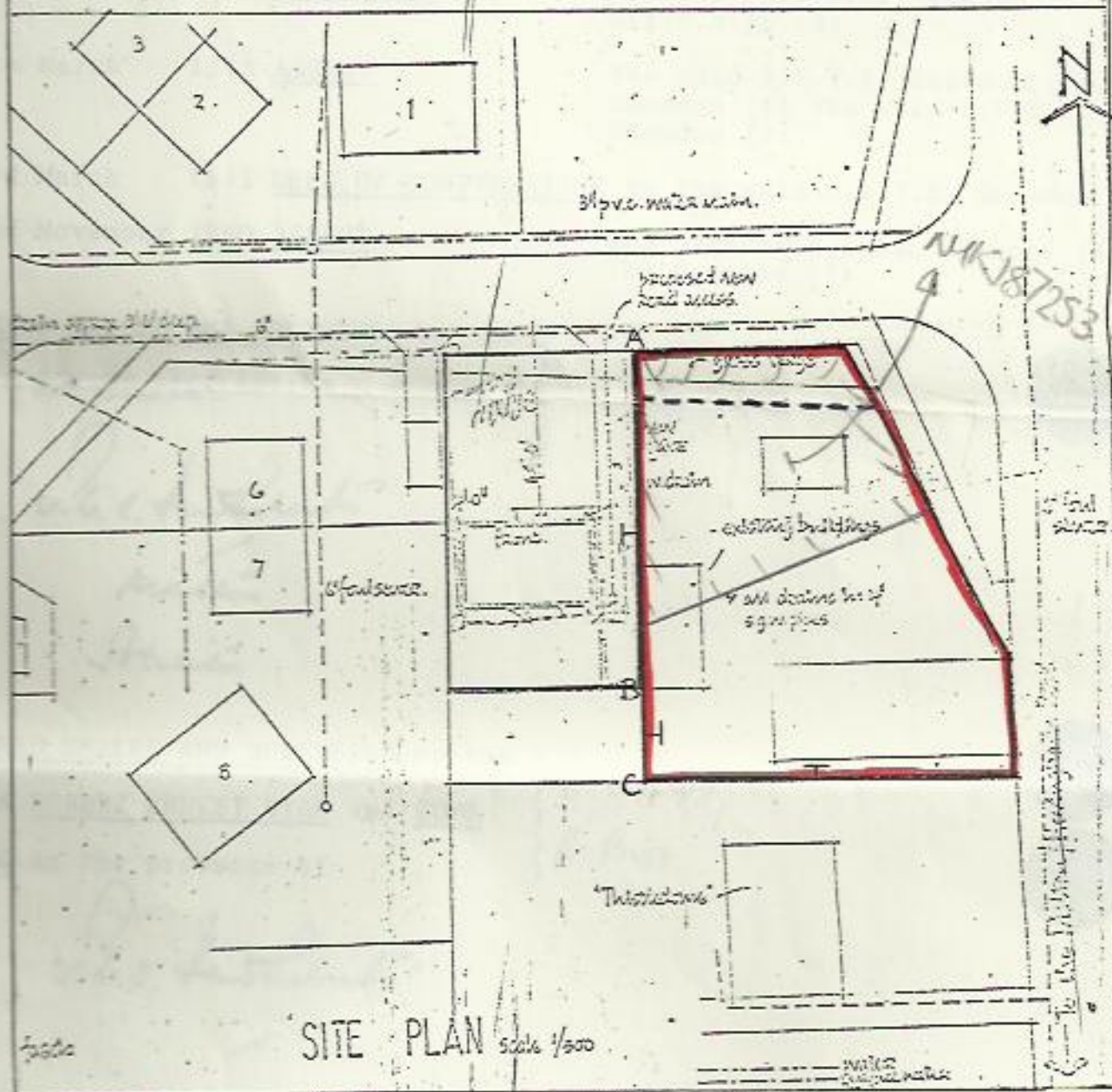

H137 (DR)

OFFICE COPY issued by

DURHAM

DISTRICT LAND REGISTRY

Title No: NYK187253

COPY (liable to distortion)

of plan to

dated

Deed of Grant  
4 July 1977

(Revised 1/76)

R. E. Bigg  
R. Bigg





Examined with the original  
at our office this 28th

October 1987

Dennis Salmon  
Malton

As Agents for North Yorkshire District  
12 Smalley Hall Park

PRESENTED

- 6 JUL 1977

No. 3955

(1)

OKIS  
only

DEED OF GIFT is made the

Fourth

day of

One thousand nine hundred and seventy seven BETWEEN  
ERNEST BIGG of "Thistledome" Broughton near Malton in the County of  
North Yorkshire Water Pollution Control Operative (hereinafter called  
"the Grantor") of the one part and ROBERT ERNEST BIGG of "Thistledome"  
Broughton aforesaid Auto-electrician the son of the Grantor and ROMA  
BIGG of the same address his wife (hereinafter called "the Donees") of  
the other part

W H E R E A S :-

- (1) The Grantor is the estate owner in respect of the fee simple  
absolute in possession of the property hereinafter described  
together with other adjoining property free from incumbrances
- (2) The Grantor is desirous of conveying the said property to the  
Donees by way of gift

NOW THIS DEED WITNESSETH as follows :-

1. IN consideration of his natural love and affection for the Donees  
the Grantor hereby conveys unto the Donees ALL THAT plot of land  
situate and fronting the Manor Park Estate Road and the Village Street  
at Broughton near Malton in the County of North Yorkshire and  
containing an area of Seven hundred and fifty four square metres or  
thereabouts as the same is for the purpose of identification only more  
particularly delineated on the plan annexed hereto and thereon edged  
round with a red verge line TOGETHER with the dwellinghouse known as  
"Fair View" and other buildings erected thereon or on some part or  
parts thereof AND TOGETHER with the benefit of the covenant on the part